

---

## INSTRUCTIONS IMPORTANT SAFEGUARDS

When using electrical equipment, basic safety precautions should always be followed including the following:

1. **READ AND FOLLOW ALL SAFETY INSTRUCTIONS**
2. Disconnect power before performing work on electrical equipment.
3. Do not let power cords touch hot surfaces and do not mount near gas or electric heaters.
4. Use caution when servicing batteries. Battery acid can cause burns to skin and eyes. If acid is spilled on skin or eyes, flush with fresh water and contact a physician immediately.
5. Equipment should be mounted in locations and at heights where unauthorized personnel will not readily subject it to tampering.
6. The use of accessory equipment not recommended by EELP, Inc. may cause an unsafe condition, and will void the unit's warranty.
7. Do not use this equipment for other than its intended purpose.
8. Servicing of this equipment should be performed by qualified service personnel.
9. Caution: halogen cycle lamps are used in this equipment. To avoid shattering, do not operate lamps in excess of rated voltage, protect lamps against abrasion and scratches and against liquid when lamps are operating. Dispose of lamps with care.
10. **SAVE THESE INSTRUCTIONS!**

---

## INSTALLATION

1. Extend unswitched 24 hour AC supply of rated voltage to junction box or appropriate wiring (supplied by others). Leave at least eight (8) inches of slack wire. The circuit should not be energized at this time.
2. Remove the polycarbonate lens by inserting a slotted screw driver into the tabs along the bottom of the assembly (Figure 1).
3. Remove the reflector assembly by inserting a slotted screw driver to depress tabs as shown in (Figure 2).
4. Once the reflector assembly is removed disconnect the wires from the battery as shown in (Figure 3).
5. Route the conduit to the conduit hub and make connection to the fixture (Figure 4).
6. Make proper wiring connections between the AC supply and the unit's transformer per diagram provided (Figure 3). **Insulate unused wire!** Connect ground to supplied green ground wire in accordance with local codes. Reassemble all wire connections and connectors. **CAUTION! - Failure to insulate unused wire may result in a shock hazard or unsafe condition as well as equipment failure. (see Batteries, below)**
7. Reconnect the battery paying attention to the polarity as shown (Figure 5).
8. Replace the reflector.
9. Aim the lamps.
10. Replace the lens.
11. Turn on the AC voltage supply.

## 1. Open the Cover

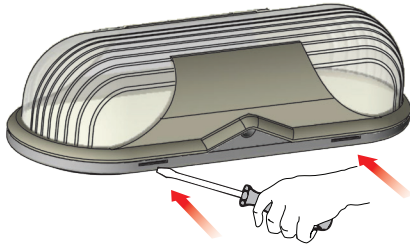

## 2. Remove the Reflector

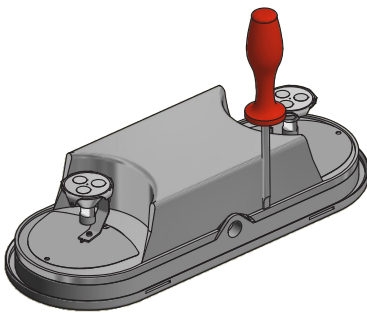

## 3. Disconnect the Wires from the Battery

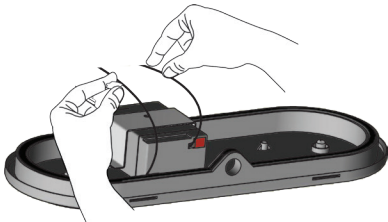

## 4. Conduit Fitting

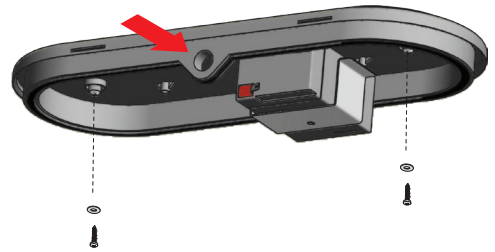

5. Reconnect the battery paying attention to the polarity as shown. Secure reflector in place. Aim the lamps to desired position and snap the lens in place.

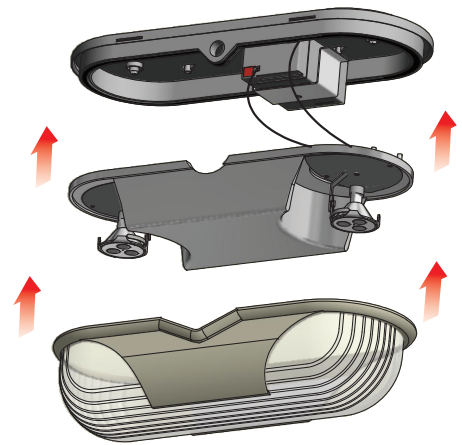

**CAUTION: ATTENTION TO THE POLARITIES!**

## MAINTENANCE

1. Clean lenses on a regular basis.

NOTE: The servicing of any parts should be performed by qualified service personnel only. The use of replacement parts not furnished by EELP, Inc., may cause equipment failure and will void the warranty.

2. The lamps listed herein when used according to the instructions with this unit are in accordance with the requirements of CSA Standard C22.2, No. 141 – Unit Equipment for Emergency Lighting.

**SAVE THESE INSTRUCTIONS**